



177 Hawthorn Crescent

Cosham, Portsmouth, PO6 2TJ

Offers in the region of £350,000



177 Hawthorn Crescent

Cosham, Portsmouth, PO6 2TJ

Offers in the region of £350,000



Welcome to Hawthorn Crescent...

Welcome to this beautifully presented, three bedroom terraced home situated on the sought after Hawthorn Crescent in the Highbury Estate. Offering a blend of modern and practical living, this is an excellent family home.

As you approach the property you are greeted by a smart, well maintained driveway, offering off road parking for two vehicles. Entering the property, you are welcomed by an inviting entrance hallway, with the living room to the right. Boasting space for multiple sofas and furnishings, with a bay window allowing an abundance of natural light to fill the room, complete with fitted blinds, this is an excellent room to relax in.

Moving through to the dining area, offering space for a large family dining table, with double doors leading out onto the garden. This flows nicely into the kitchen, which is well equipped with a range of wall and floor mounted units, ample work top space, a combi oven, a gas hob with extractor fan, plumbing for both a dishwasher and washing machine, and a sink with drainer. There is an additional rear door leading out onto the garden, which has been beautifully landscaped with paved floors, complete with a hot tub, this is an excellent space for relaxing in the sun.

Also on the ground floor is a convenient downstairs toilet.

On the first floor, you will find three bedrooms and the family bathroom. Bedroom one and two are generously sized, offering space for king sized beds, wardrobes and other furnishings. Bedroom three makes a great children's room, home office, or walk in wardrobe.

The family bathroom comprises of tiled floors and walls, a bath with over head shower, toilet, sink and towel radiator.

With stairs leading up to the second floor, you find a further room which could be used in a variety of ways, making a great home office or additional storage room, complete with Velux windows.

The property benefits from double glazing throughout and gas central heating.

Situated on the Highbury Estate, you are close to many local amenities, transport links and good schools. Cosham high street offers a range of shops, takeaways and cafes, with the train station being half a miles walk away.

This is an excellent family home, a viewing is highly advised to appreciate what this property has to offer. Please contact the office to arrange your appointment.



Road Map



Hybrid Map



Terrain Map



Floor Plan

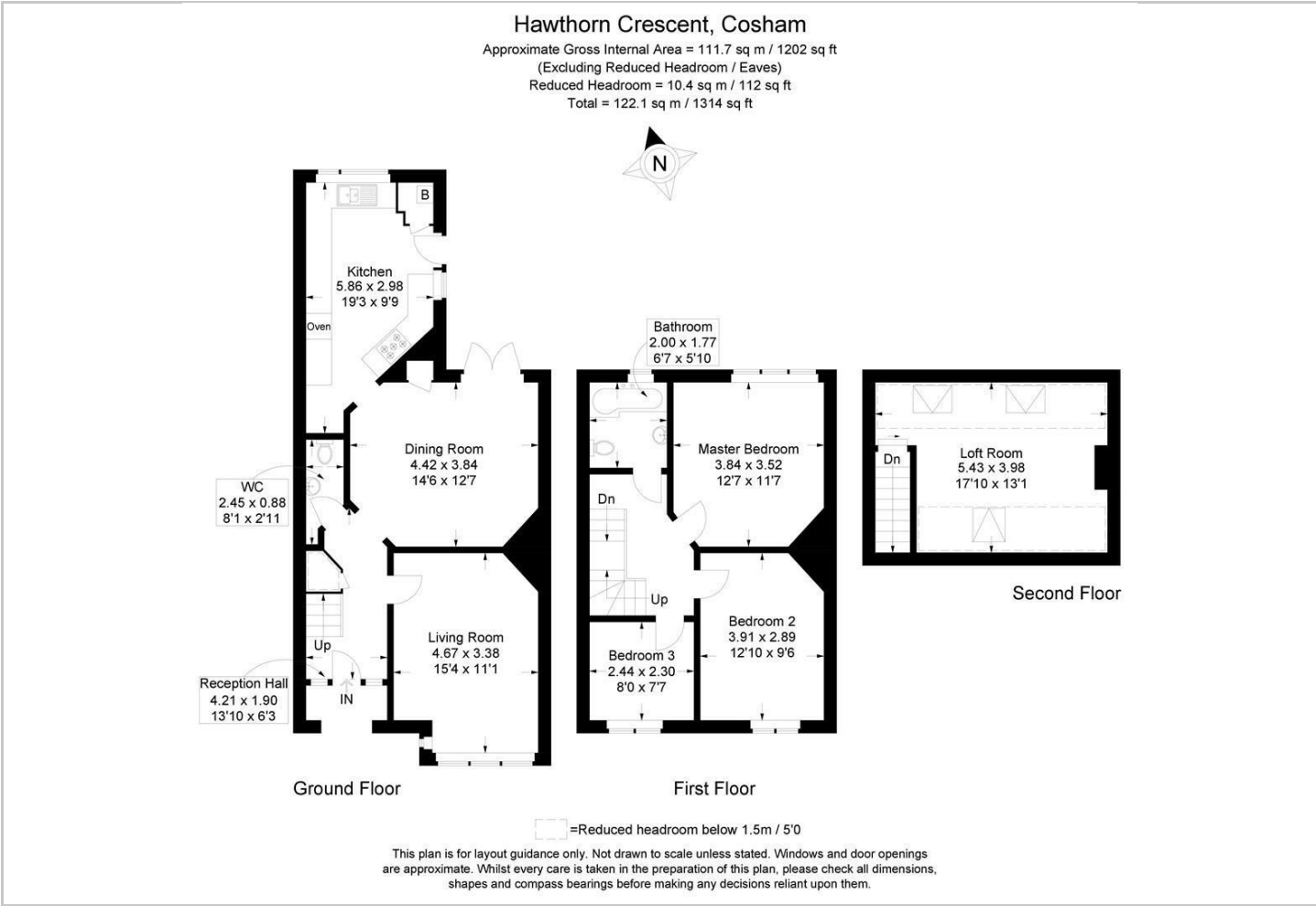

Viewing

Please contact our Central Office on 02394 217317 if you wish to arrange a viewing appointment for this property or require further information.

Energy Efficiency Graph

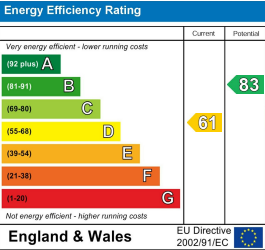

These particulars, whilst believed to be accurate are set out as a general outline only for guidance and do not constitute any part of an offer or contract. Intending purchasers should not rely on them as statements of representation of fact, but must satisfy themselves by inspection or otherwise as to their accuracy. No person in this firm's employment has the authority to make or give any representation or warranty in respect of the property.